



Sump Strainers

48 Series Male Thread

1-2. Steel Hex Pipe Nipple:

In a full range of NPT sizes, $\frac{3}{8}$ " thru 3". Welded on.

3. Steel Support Tube:

Provides rigidity, permits easy cleaning and better flow.

4. Pleated, Reusable Stainless Wire Cloth:

Keeps its shape and allows better flow. For use with hydraulic fluids, oils, coolants, cutting oils and lubricants. Excellent for mobile equipment. Easily cleaned. Choice of 30, 60, 100 or 200 mesh. See Ordering Code.

5. Plated Steel Cap End:

Epoxy-bonded for one-piece construction.

Trouble-Free Positive Protection:

No organic elements to deteriorate. These smooth, one-piece, epoxy-bonded units are carefully and compactly constructed with quality materials throughout. They assure trouble-free, positive protection for the entire system. Excellent for mobile equipment.

Easily Installed and Cleaned:

Easily removed and cleaned with gasoline and similar solvents.

Operating Temperature

15F° (-9 C) to 212 F° (100C)

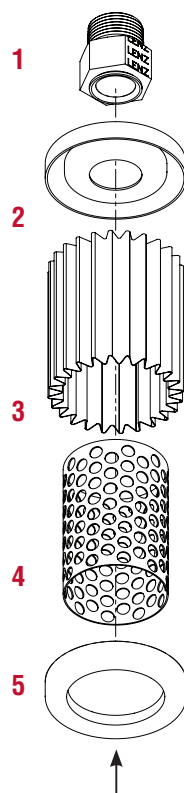

OPTIONAL:
Built-in relief valve to
prevent pump starvation
Add R3 or R5



48-XX-XXX-MAG

OPTIONAL:
Bypass Valves
3 P.S.I./ 6" HG 5 P.S.I./ 10" HG \pm 10%

Magnetic Bands
Optional magnets are available

48 Series Performance Graphs

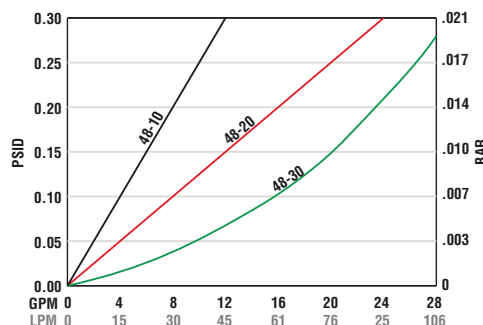
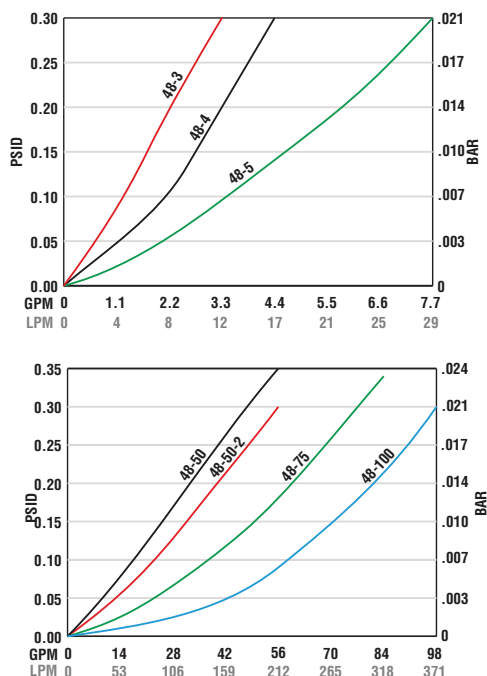

Temperature 100° F Viscosity 150 SUS
Average pressure drop through clean strainer

See Technical Bulletin TB.FIL17.708, TB.FIL19.708, or further information at
(Technical Data – www.lenzinc.com)

Strainer Ordering Code

48 — 20 — R3 — 100 — MAG

SERIES	FLOW	SIZE	BYPASS	MESH	OPTIONS
48	3	3/8" NPT	OMIT NO BYPASS	100 100 MESH (STANDARD)	OMIT
	4	1/2" NPT	R3 3 PSI BYPASS	30 30 MESH	MAG MAGNETS
	5	3/4" NPT	R5 5 PSI BYPASS	60 60 MESH	
	10	1" NPT		200 200 MESH	
	20	1 1/4" NPT			
	30	1 1/2" NPT			
	50	1 1/2" NPT			
	50-2	2" NPT			
	75	2 1/2" NPT			
	100	3" NPT			

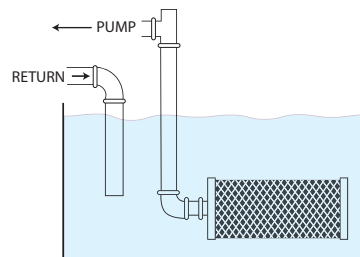
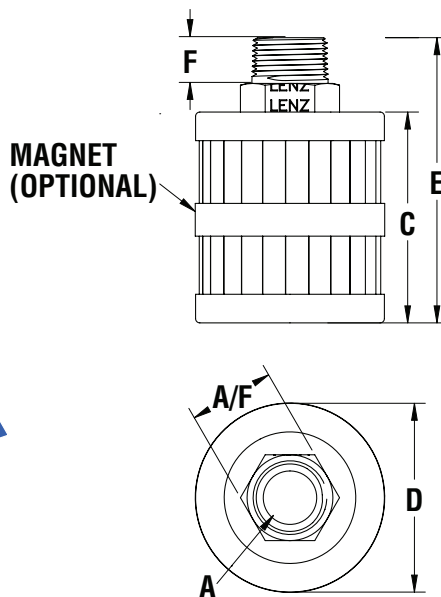
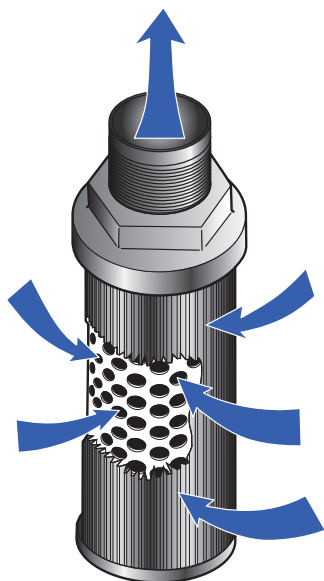

Typical Single Unit Installation

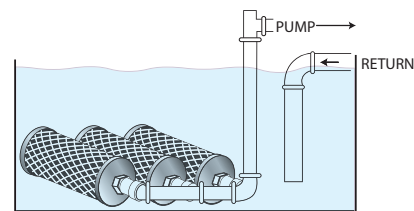

Typical Multiple Unit Installation

Dimensional Details

MODEL	FLOW GPM / LPM		NPT PORT A	C	D	E	F	HEX DIA A/F	AREA IN ² CM ²
48-3	3 GPM	IN	3/8	1.2	2.0	2.2	0.6	1.0	34
	11 LPM	MM		30	52	56.4	16	25.4	(219)
48-4	5 GPM	IN	1/2	1.9	2.6	2.9	0.6	1.0	62
	20 LPM	MM		48	66	74	16	25.4	(400)
48-5	8 GPM	IN	3/4	2.9	2.6	3.9	0.6	1.2	86
	30 LPM	MM		74	66	99.7	16	30	(555)
48-10	10 GPM	IN	1	4.6	2.6	5.6	0.6	1.5	110
	40 LPM	MM		117	66	142.8	16	38	(710)
48-20	20 GPM	IN	1 1/4	6.1	3.3	7.4	0.8	2.2	162
	80 LPM	MM		155	85	189	21.5	55	(1045)
48-30	30 GPM	IN	1 1/2	7.2	3.9	8.8	0.9	2.2	225
	120 LPM	MM		183	100	222.9	23	55	(1452)
48-50	50 GPM	IN	1 1/2	9.1	3.9	10.7	0.9	2.2	340
	200 LPM	MM		231	100	271	23	55	(2193)
48-50-2	50 GPM	IN	2	9.1	3.9	10.7	0.9	2.6	340
	200 LPM	MM		231	100	271.1	23	65	(2193)
48-75	75 GPM	IN	2 1/2	9.1	5.1	10.9	1.2	3.3	400
	285 LPM	MM		231	130	277	30	85	(2581)
48-100	100 GPM	IN	3	10.4	5.1	12.2	1.2	3.9	500
	380 LPM	MM		264	130	310	30	100	(3226)