



Canister Filters/Disposable Type

Suction or Return Line Application

Model Series CP-1030

Specifications

- Working pressure 200 PSI (14 Bar) 80 PSI ΔP w/o bypass
- Operating Temperatures -22°F to +212°F (-32°C to +100°C)
- Flows to 25 GPM (96 LPM) Return
- Flows to 5 GPM (19 LPM) Suction
- 1" Ports
- Aluminum Casting — Die Cast
- Buna Seals
- Compatible with mineral oils HH, HL, HM, HR, HV, HG, water according to ISO 6743/4
- Element post threads 1 1/8"-16 UNF
- 2-3 (lbs.), 1.4 (kgs.) shipping weight

Options

- NPT or SAE Ports
- 10, micron cellulose
- Visual or electrical indicators
- 2.5, 5, 15, 25, blocked bypass options for suction or return

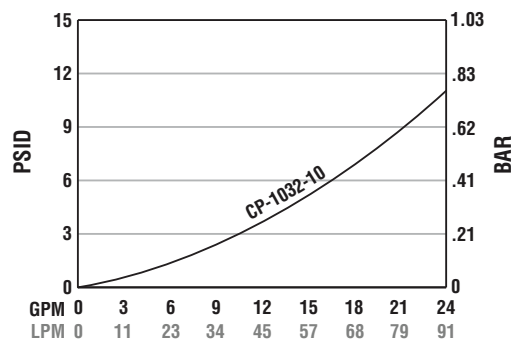

CP-1030 Series



CP-1032-10

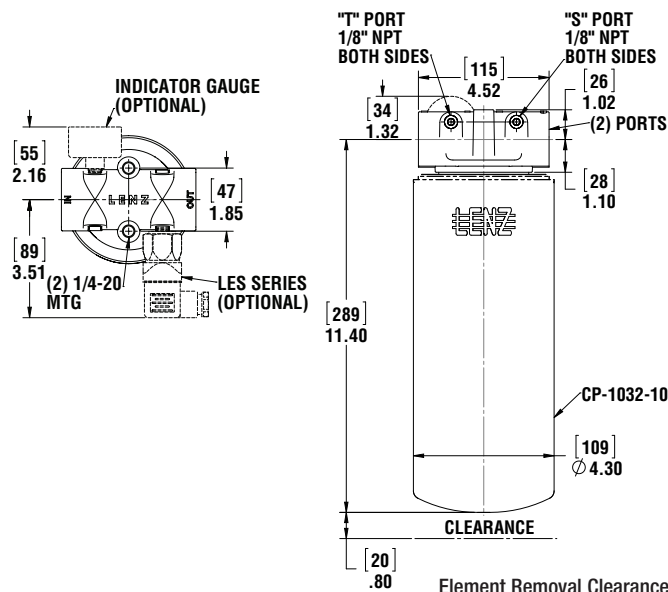

Assembly Ordering Code

CP — 1030 — 10 — P — T

| Series | Model | Media | Model | Bypass | Ind. Ports |
|---------|-------|-------|-----------|---------------|-------------------|
| CP NPT | 1030 | 10 | 10 Micron | P (15 PSI) | Omit None |
| CPA SAE | | | Cellulose | R (25 PSI) | T 1/8 NPT Return |
| | | | | V (5 PSI) | S 1/8 NPT Suction |
| | | | | H (2.5 PSI) | T, S ALL PORTS |
| | | | | B (NO Bypass) | |



For indicator gauge specifications and ordering information see pages 38a-39a

**Indicators ordered and shipped separately*

Filter Head Ordering Code

CP — 1031 — R — T —

| Series | Ports | Bypass | Ind. Ports | Indicators |
|---------|-------|-------------|-------------------|---------------|
| CP NPT | 1031 | P (15 PSI) | Omit None | Omit |
| CPA SAE | | H (2.5 PSI) | T 1/8 NPT Return | (T) MC-12 |
| | | R (25 PSI) | S 1/8 NPT Suction | (T) MC-20 |
| | | V (5 PSI) | | (T,S) CP-2 |
| | | B None | | (T) GLY-MC-20 |
| | | | | (S) 135080 |
| | | | | (S) VAC-3-20 |
| | | | | DP-75 |
| | | | | (T) LES-P1 |
| | | | | (T) LES-P2 |
| | | | | (S) LES-V1 |

Replacement Elements

| Model Number | Media Type Micron | In Area | CM Area | Element Thread | Rating B(X)=2/20/75 | Dirt Holding Capacity (Grams) |
|--------------|-------------------|---------|---------|----------------|---------------------|-------------------------------|
| CP-1032-10 | 10 Cellulose | 1672 | 10787 | 1 1/8-16 UNF | 8/33/53 | 54 |

Beta Rating Of 2 = 50 % Efficiency
Beta Rating Of 20 = 95 % Efficiency
Beta Rating Of 75 = 98.7 % Efficiency
Note: 80 PSI Pressure Drop Maximum
Without Bypass Valve In Filter Head



General Filter Specifications

Bypasses

Differential opening set value + - 10%

Medias

| | |
|----------------------|--------------------------------------|
| Cellulose | Resin impregnated paper |
| Synthetic | Inorganic micro fiber |
| Wire Mesh | 140 micron, 100 mesh stainless Steel |
| Water Removal | 10 micron resin impregnated paper |

Compatibility of Fluids with

Filter Heads & Bowls Per ISO 6743/4

Mineral oils (types HH, HL, HM, HR, HV)
Water based emulsions (types HFAE, HFAS)
Synthetic fluids (types HS, HFDR, HFDS, HFFU)
Water glycol (types HFC)



LIT-1252-Bypass



LIT-1252-10P



CP-752-10

Compatibility of Fluids with Filter Elements Per ISO 2943

Mineral oils (types HH, HL, HM, HR, HV, HG) ISO 6743/4
Synthetic fluids (types A & M series only)
Water based emulsions consult Lenz for further information

Compatibility of Fluids with Seals Per ISO 6743/4

Nitrile (Buna N)

Mineral Oils (HH, HL, HM, HR, HV, HG)
Water emulsion (HFAE, HFAS)
Water glycol (HFC)

Viton seals

Synthetic fluids (types HS, HFDR, HFDS, HFDU)

Indicator Options

| | |
|---------------------|--------------------------------------|
| Visual | Suction & return visual gauges |
| Electrical | Suction & return electrical switches |
| Differential | Return indicators |

Mineral Oil Types

| | |
|-----------|---|
| HH | Non inhibited refined mineral oils |
| HL | Refined mineral oils with anti-oxidation and anti-rust properties |
| HM | HL fluids with improved anti wear |
| HR | HL oils with VI improvers |
| HV | Lubricants with high viscosity |
| HG | HM oils with anti-stick slip properties |

Water Based Emulsion Types

| | |
|-------------|--|
| HFAE | Oil water emulsions or aqueous fluids which are further with additional letters |
| HFAS | Solutions of chemicals containing minimum 80% of water |
| HFC | Aqueous solutions with viscosity-increasing additives and minimum 35% mass water |

Synthetic Fluid Types

| | |
|-------------|---|
| HFDU | Fire resistant fluids of other compositions |
| HFDS | HFD based upon phosphoric acid ester |
| HS | Synthetic fluids with no specific fire resistant properties |
| HFDR | HFD based on halogen-containing compounds |





2" Diameter Filter Indicating Gauges



MC-12

Return Line Indicating Gauge
for 15 PSI Filter Applications
2" Multi color

0-12 PSI Green
12-15 PSI Yellow
15-60 PSI Red (Service Filter)
(To be used with "T" Indicator Port Location)



MC-20

Return Line Indicating Gauge
for 25 PSI Filter Applications
2" Multi color

0-20 PSI Green
21-24 PSI Yellow
25-60 PSI Red (Service Filter)
(To be used with "T" Indicator Port Location)



CHANGE FILTER

CP-2

Compound Indicating Gauge
(Suction or Return Line)

10" to 30" Vacuum is a Red Danger Area.
0-60 PSI
A Red "Change Filter" Sticker for the
Pressure side is included with each gauge
for application after the pressure factor
is determined.
(To be used with "T" or "S" Indicator Port Location)



GLY-MC-20

Glycerin Filled
Return Line Indicating Gauge
for 25 PSI Filter Applications
2" Multi color

0-20 PSI Green
21-24 PSI Yellow
25-60 PSI Red (Service Filter)
(To be used with "T" Indicator Port Location)



135080

Suction Line Indicating Gauge for
5 PSI vacuum filter application
2" Multi color

0-9" HG Green
9-11" HG Yellow
11-30" HG Red (Service Filter)
(To be used with "S" Indicator Port Location)

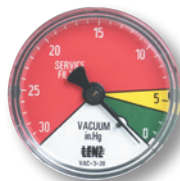

VAC-3-20

Suction Line Indicating Gauge
for 3 PSI vacuum filter applications
2" Multi color

0-3" HG Green
4-6" HG Yellow
6-30" HG Red (Service Filter)
(To be used with "S" Indicator Port Location)



Differential Indicator DP-75

Simple differential sliding
indicator which changes from
green to red at 7 PSID.

0 - 7 PSID. Green Clean
7 - 10 PSID. Red Service Filter
CP Series (500, 750, 1010, 1280,
1580)

*Indicators ordered and shipped separately

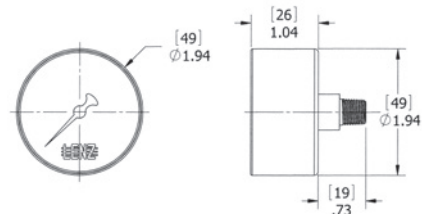

DIAL INDICATOR

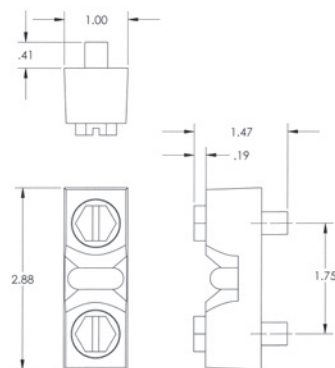

DP-75



Electrical Filter Indicators

Field Adjustable

Specifications:

- 1/8 NPT connection
- 3 AMP 12/24 VDC, 125/250 VAC IP67
- +/- 2% repeatability of full set point range @ 70°F
- Operating temperature 40°F to +250°F (-40°C to 121°C)
- 1,000,000 cycles mechanical range
- Maximum pressure 500 (25 BAR) PSI
- Steel housing, zinc plated
- Buna N diaphragm
- SPDT snap action switch

Options:

- EPDM seals -10°F – 250°F (-23°C – 121°C)
- Viton seals 0 – 250°F (-18°C – 121°C)
- Flying leads



LES-FL



LES-HC

| Model | Adjustment Range | Average Differential | Set Pressure |
|-------|---------------------------|--------------------------|--------------|
| P1 | 3-20 PSI (.2-1.4 BAR) | 2-5 PSI (.13-0.4 BAR) | 15 PSI |
| P2 | 15-80 PSI (1.03-6 BAR) | 4-7 PSI (.27-0.5 BAR) | 22 PSI |
| V1 | 5-28 in Hg (160-948mb) | 2-4 INHg (67-135mb) | 5 Hg |

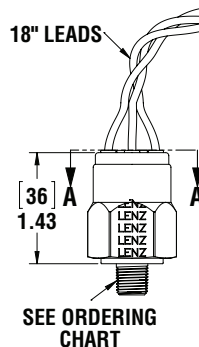
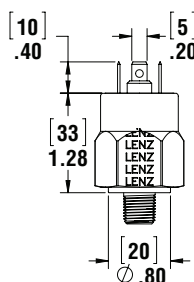
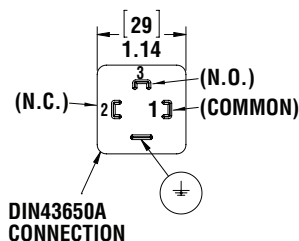
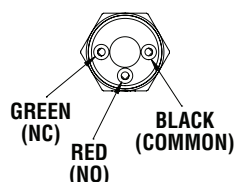
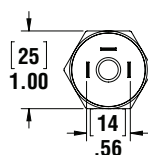

SEE ORDERING CHART

LES-FL

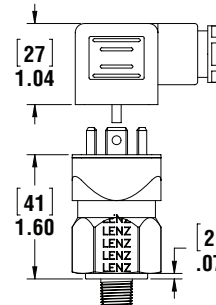

LES-HC

Switch Ordering Code

LES – P1 – 2N – B – HC –

| Series | Adjustment Range | Thread | Seals | Electrical Connection | Options |
|--------|--|--|-----------------------------|---------------------------------|--|
| LES | P1 3-20 PSI P2 15-80 PSI V1 5-30" HG Rising | 2N 1/8" NPT 4N 1/4" NPT 4S 7/16"-20 6S 9/16"-18 | B Buna V Viton E EPDM | FL Flying Leads HC Din Clamp | Omit SS Stainless Housing IL Ind Light |

**Indicators ordered and shipped separately*

Switch can be used in AC or DC Service.
For other options consult factory.
Switch does not indicate differential pressure

See Technical Bulletin TB.FIL23.912, or further information at
(Technical Data – www.lenzinc.com)