



## Magnetic Drain Plugs

### AMDP, MDP Magnetic Drain Plug

LENZ Magnet Plugs are similar to standard pipe or straight thread drain plugs with one important difference, a permanent magnet is fastened to the plug body. This magnet attracts and holds abrasive, ferrous metal particles preventing their circulation through the lubrication or hydraulic system.

These abrasive, ferrous metal particles appear in lubricating or hydraulic systems as a result of the following conditions:

- The constant flaking effect of normal wear of moving parts
- Particles not removed by flushing operations after boring or machining.
- Chipping due to sub-surface casting flaws.
- Minute component breakdown caused by stress usage.

Usually a combination of factors accounts for the presence of these particles that cause excessive wear to vital components unless they are removed. By holding these particles, LENZ Magnetic Drain Plugs prevent excessive wear to the system's components.

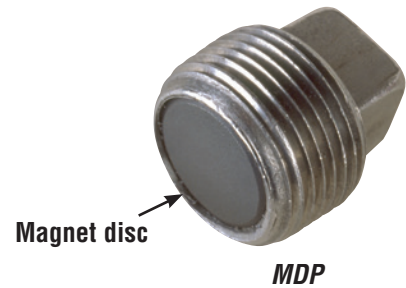

### Dimensional Detail

Model Number	Port Size	Magnet Style	Overall A Length in. mm	B Body Length in. mm	Magnet Projection in. mm	C Head Size in. mm	Head Depth in. mm	Body Material	Style
MDP-4	1/4" NPT	Bar Alnico V	.96 (24)	.45 (11)	.23 (6)	.37 9	.28 7	Steel	Square Head
MDP-6	3/8" NPT	Disc Ferrite	.80 (20)	.47 (11)	.21 (5)	.43 11	.34 9	Steel	
MDP-8	1/2" NPT	Disc Ferrite	.96 (24)	.57 (14)	—	.56 14	.38 10	Steel	
MDP-12	3/4" NPT	Disc Ferrite	1.11 (28)	.62 (15)	—	.62 16	.45 11	Steel	
MDP-16	1" NPT	Disc Ferrite	1.52 (38)	.75 (19)	—	.81 21	.52 13	Mal. Iron	

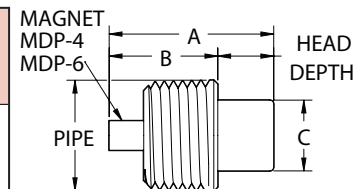

See website technical bulletin TB.TA27.914 for further information at (Technical Data - [www.lenzinc.com](http://www.lenzinc.com)).

### Dimensional Detail

Model Number	Port Size	Magnet Style	Overall A Length in. mm	B Body Length in. mm	Magnet Projection in. mm	C Head Size in. mm	Head Depth in. mm	Body Material	Style
AMDP-6	9/16"-18 SAE	Disc Ferrite	.48 (12)	.38 (10)	—	.63 16	.28 7	Steel	Hollow Hex
AMDP-8	3/4"-16 SAE	Disc Ferrite	.56 (14)	.44 (11)	—	.83 21	.32 8	Steel	
AMDP-10	7/8"-14 SAE	Disc Ferrite	.63 (16)	.47 (12)	—	.96 24	.40 10	Steel	
AMDP-12	1 1/16"-12 SAE	Disc Ferrite	.75 (19)	.47 (12)	—	1.13 29	.40 10	Steel	
AMDP-16	1 5/16"-12 SAE	Disc Ferrite	.75 (19)	.47 (12)	—	1.38 35	.40 10	Steel	
AMDP-20	1 5/8"-12 SAE	Disc Ferrite	.75 (19)	.47 (12)	—	1.70 43	.40 10	Steel	

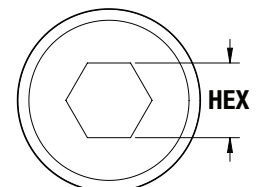
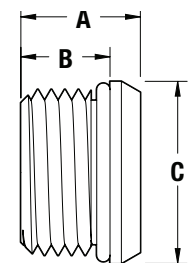
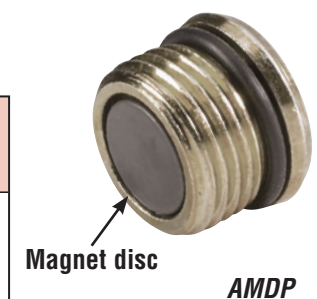

See website technical bulletin TB.TA27.914 for further information at (Technical Data - [www.lenzinc.com](http://www.lenzinc.com)).