



In-Tank Filters Disposable Filter Cartridge Type

Return Line Application Series LITA-1010

Specifications

- Working pressure 100 PSI (7 Bar)
- Operating Temperatures -22°F to +212°F (-32°C to +100°C)
- Flows to 40 GPM (160 LPM) return
- 1" Port Aluminum casting
- Buna Seals
- Compatible with mineral oils HH, HL, HM,HR,HV, HG, and water based emulsions HFAE, HFAS according to ISO 6743/4
- Nylon bowl
- 3 (lbs), 1.4 (kgs) shipping weight

Options

- 1" NPT Ports, non stock
- 10, 25 micron cellulose, synthetic elements
- 25" PSI bypass
- Visual or electrical indicator

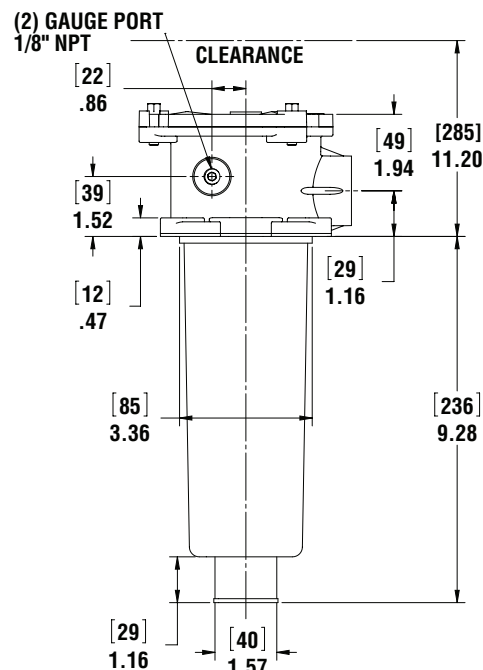
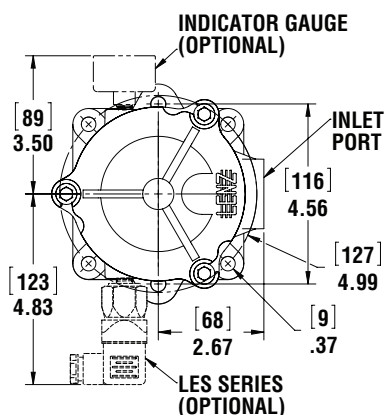
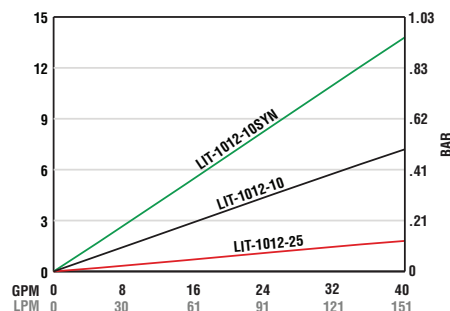

Replacement Elements

Element Number	Area In ²	Cm01 ²	Dirt Holding Capacity	B=2/20/75
LIT-1012-10SYN	212	1367	12	3μ/5.5μ/12μ
LIT-1012-10	254	1638	8	6μ/8μ/13μ
LIT-1012-25	254	1638	10	24μ/35μ/43μ

Beta Rating of 2 = 50% Efficiency
Beta Rating of 20 = 95% Efficiency
Beta Rating of 75 = 98.7% Efficiency
Note: 80 PSI Pressure Drop Maximum
Without Bypass Valve in Filter Head

Assembly Ordering Code

LITA - 1010 - 10 - R - T

Series	Port Type	Model	Media	Model	Bypass	Ind. Ports
LITA	SAE	1010	10	10 Micron	R (25 PSI)	Omit
LIT	NPT		10 SYN	10 Micron		None
			25	25 Micron		1/8 NPT Return

See Technical Bulletin TB.FIL09.708, TB.FIL11.708, TB.FIL20.708, for further information at (Technical Data - www.lenzinc.com)

For indicator gauge specifications and ordering information see pages 38a-39a

**Indicators ordered and shipped separately*





General Filter Specifications

Bypasses

Differential opening set value + - 10%

Medias

Cellulose	Resin impregnated paper
Synthetic	Inorganic micro fiber
Wire Mesh	140 micron, 100 mesh stainless Steel
Water Removal	10 micron resin impregnated paper

Compatibility of Fluids with

Filter Heads & Bowls Per ISO 6743/4

Mineral oils (types HH, HL, HM, HR, HV)
Water based emulsions (types HFAE, HFAS)
Synthetic fluids (types HS, HFDR, HFDS, HFFU)
Water glycol (types HFC)



LIT-1252-Bypass



LIT-1252-10P



CP-752-10

Compatibility of Fluids with Filter Elements Per ISO 2943

Mineral oils (types HH, HL, HM, HR, HV, HG) ISO 6743/4
Synthetic fluids (types A & M series only)
Water based emulsions consult Lenz for further information

Compatibility of Fluids with Seals Per ISO 6743/4

Nitrile (Buna N)

Mineral Oils (HH, HL, HM, HR, HV, HG)
Water emulsion (HFAE, HFAS)
Water glycol (HFC)

Viton seals

Synthetic fluids (types HS, HFDR, HFDS, HFDU)

Indicator Options

Visual	Suction & return visual gauges
Electrical	Suction & return electrical switches
Differential	Return indicators

Mineral Oil Types

HH	Non inhibited refined mineral oils
HL	Refined mineral oils with anti-oxidation and anti-rust properties
HM	HL fluids with improved anti wear
HR	HL oils with VI improvers
HV	Lubricants with high viscosity
HG	HM oils with anti-stick slip properties

Water Based Emulsion Types

HFAE	Oil water emulsions or aqueous fluids which are further with additional letters
HFAS	Solutions of chemicals containing minimum 80% of water
HFC	Aqueous solutions with viscosity-increasing additives and minimum 35% mass water

Synthetic Fluid Types

HFDU	Fire resistant fluids of other compositions
HFDS	HFD based upon phosphoric acid ester
HS	Synthetic fluids with no specific fire resistant properties
HFDR	HFD based on halogen-containing compounds





2" Diameter Filter Indicating Gauges



MC-12

Return Line Indicating Gauge
for 15 PSI Filter Applications
2" Multi color

0-12 PSI Green
12-15 PSI Yellow
15-60 PSI Red (Service Filter)
(To be used with "T" Indicator Port Location)



MC-20

Return Line Indicating Gauge
for 25 PSI Filter Applications
2" Multi color

0-20 PSI Green
21-24 PSI Yellow
25-60 PSI Red (Service Filter)
(To be used with "T" Indicator Port Location)



CP-2

Compound Indicating Gauge
(Suction or Return Line)

10" to 30" Vacuum is a Red Danger Area.
0-60 PSI
A Red "Change Filter" Sticker for the
Pressure side is included with each gauge
for application after the pressure factor
is determined.
(To be used with "T" or "S" Indicator Port Location)



GLY-MC-20

Glycerin Filled
Return Line Indicating Gauge
for 25 PSI Filter Applications
2" Multi color

0-20 PSI Green
21-24 PSI Yellow
25-60 PSI Red (Service Filter)
(To be used with "T" Indicator Port Location)



135080

Suction Line Indicating Gauge for
5 PSI vacuum filter application
2" Multi color

0-9" HG Green
9-11" HG Yellow
11-30" HG Red (Service Filter)
(To be used with "S" Indicator Port Location)



VAC-3-20

Suction Line Indicating Gauge
for 3 PSI vacuum filter applications
2" Multi color

0-3" HG Green
4-6" HG Yellow
6-30" HG Red (Service Filter)
(To be used with "S" Indicator Port Location)



Differential Indicator DP-75

Simple differential sliding
indicator which changes from
green to red at 7 PSID.

0 - 7 PSID. Green Clean
7 - 10 PSID. Red Service Filter
CP Series (500, 750, 1010, 1280,
1580)

*Indicators ordered and shipped separately

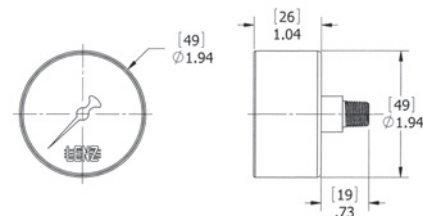

DIAL INDICATOR

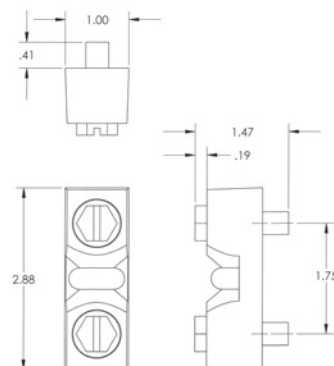

DP-75



Electrical Filter Indicators

Field Adjustable

Specifications:

- 1/8 NPT connection
- 3 AMP 12/24 VDC, 125/250 VAC IP67
- +/- 2% repeatability of full set point range @ 70°F
- Operating temperature 40°F to +250°F (-40°C to 121°C)
- 1,000,000 cycles mechanical range
- Maximum pressure 500 (25 BAR) PSI
- Steel housing, zinc plated
- Buna N diaphragm
- SPDT snap action switch

Options:

- EPDM seals -10°F – 250°F (-23°C – 121°C)
- Viton seals 0 – 250°F (-18°C – 121°C)
- Flying leads



LES-FL



LES-HC

Model	Adjustment Range	Average Differential	Set Pressure
P1	3-20 PSI (.2-1.4 BAR)	2-5 PSI (.13-0.4 BAR)	15 PSI
P2	15-80 PSI (1.03-6 BAR)	4-7 PSI (.27-0.5 BAR)	22 PSI
V1	5-28 in Hg (160-948mb)	2-4 INHg (67-135mb)	5 Hg

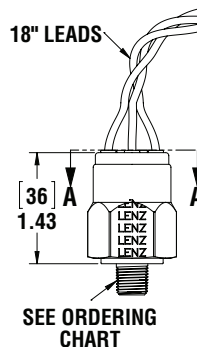
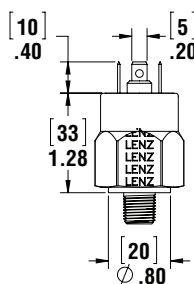
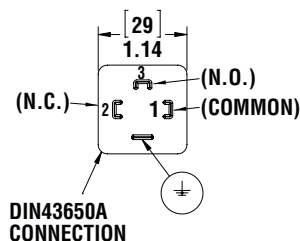
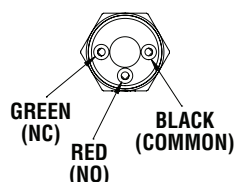
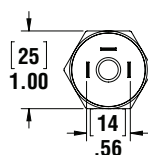

LES-FL

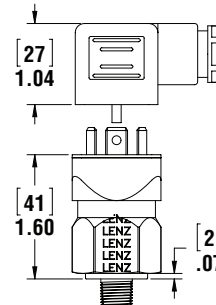

LES-HC

Switch Ordering Code

LES – P1 – 2N – B – HC –

Series	Adjustment Range	Thread	Seals	Electrical Connection	Options
LES	P1 3-20 PSI P2 15-80 PSI V1 5-30" HG Rising	2N 1/8" NPT 4N 1/4" NPT 4S 7/16"-20 6S 9/16"-18	B Buna V Viton E EPDM	FL Flying Leads HC Din Clamp	Omit SS Stainless Housing IL Ind Light

**Indicators ordered and shipped separately*

Switch can be used in AC or DC Service.
For other options consult factory.
Switch does not indicate differential pressure

See Technical Bulletin TB.FIL23.912, or further information at
(Technical Data – www.lenzinc.com)